

SOCIAL RESPONSIBILITY WITHIN AN IRRADIATION FACILITY

Docters, A¹, Lucuix, MB.²

Comisión Nacional de Energía Atómica (CNEA), Av. Del Libertador 8259, Buenos Aires- Argentina.

¹ docters@cae.cnea.gov.ar

² lucuix@cnea.gov.ar

1. INTRODUCTION

A great diversity of products are treated with ionizing radiation for sterilization, decontamination and preservation purposes, among others. The Planta de Irradiación Semi-Industrial -PISI- was Argentina's first irradiation facility and was designed and built in 1970 by the *Comisión Nacional de Energía Atómica (Argentina)*.

Many visitors are annually introduced to the applications of this technology and show a high level of acceptance of the radiation process, but however advantageous this technology might be, community in general is highly concerned about the risks it might involve, specially people with superficial or inaccurate knowledge.

It is in this framework we decided in 2007 to develop a project in order to evaluate the feasibility of integrating a social responsible behaviour into our facility with existing strategies and specific safety and security requirements.

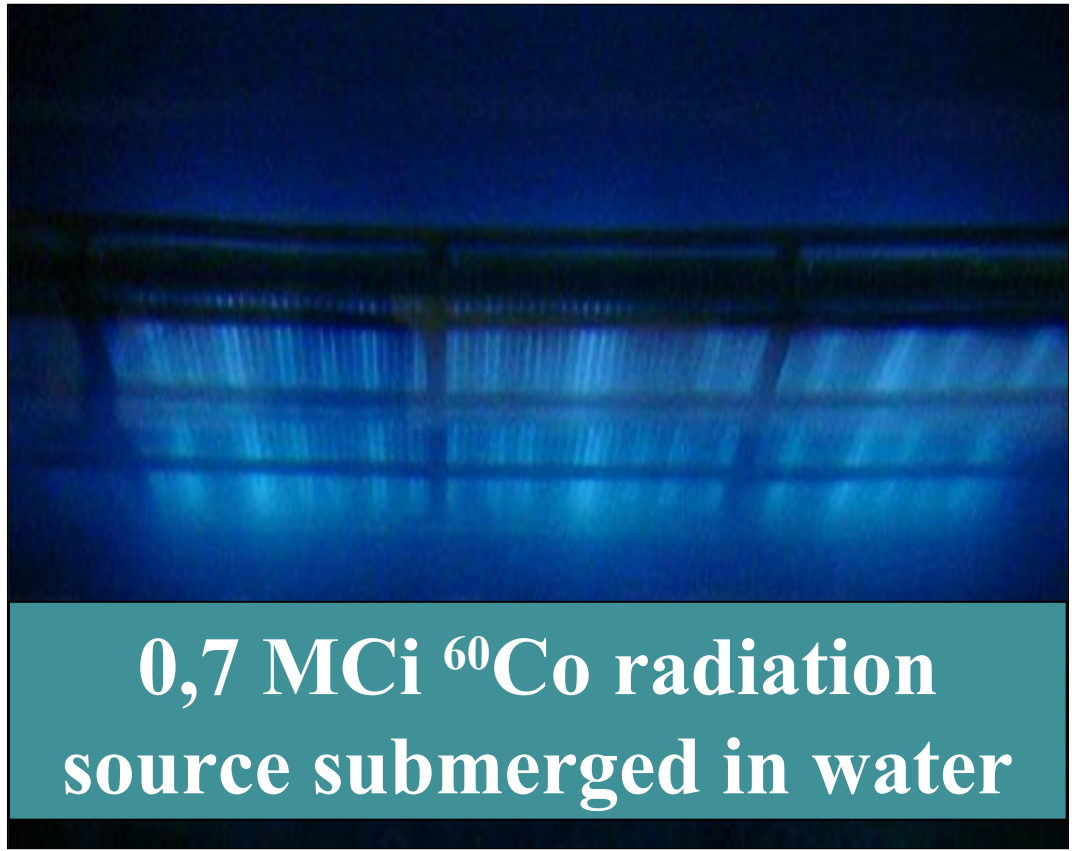
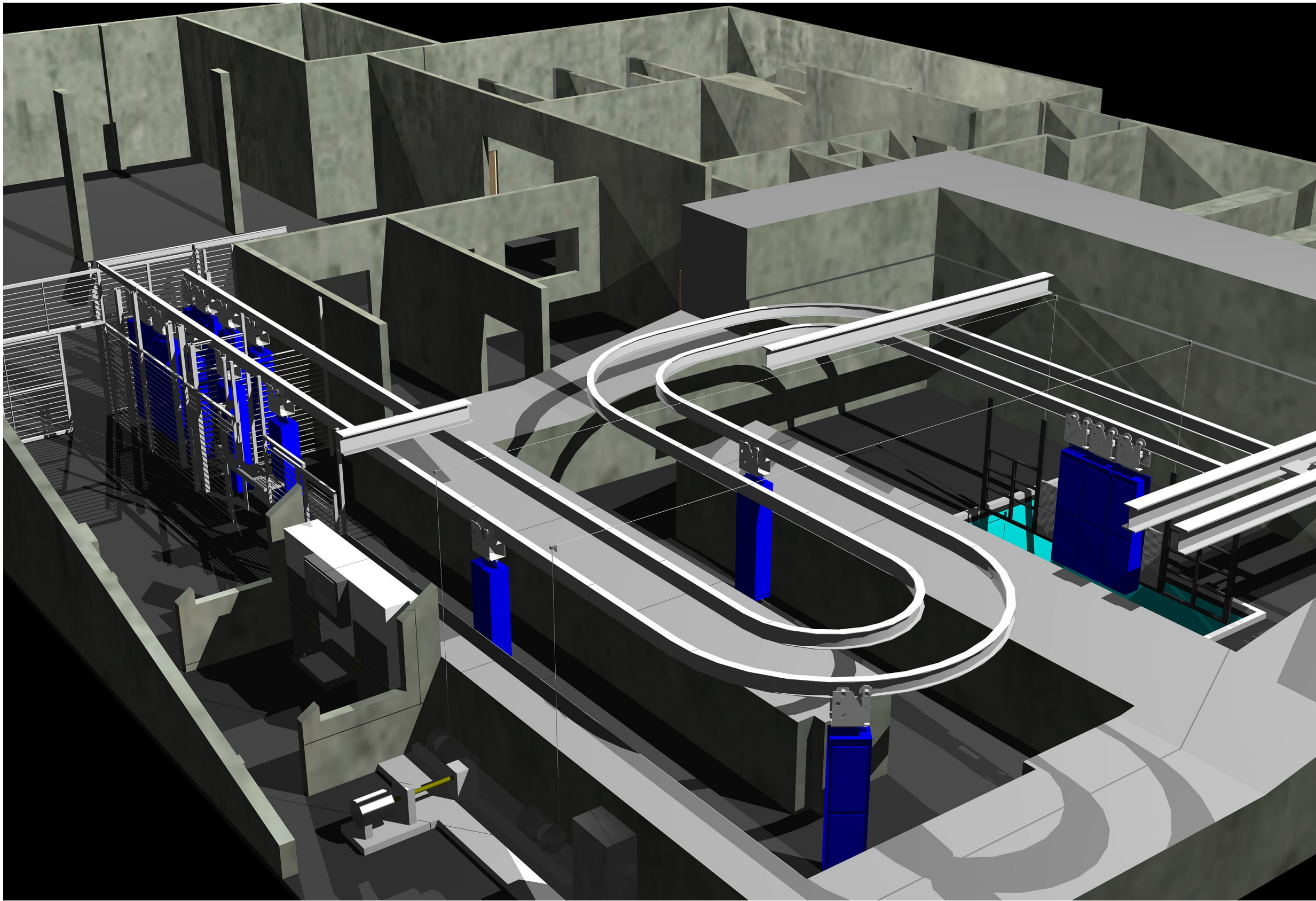

2. OBJECTIVES

Strengthening of our relationship with the community and stakeholders

Reinforcement of our safety and security culture by increasing PISI's human capital

Integrating social responsibility with safety, health, environment, security, quality, good irradiation practices and economic elements

3. WHY ISO 26.000?

Based on international consensus between representatives of a wide range of stakeholders, this guide is applicable to all type of organizations in both developed and developing countries.

4. INITIAL STEPS TOWARDS THE IMPLEMENTATION OF SOCIAL RISPONSIBILITY AT PISI

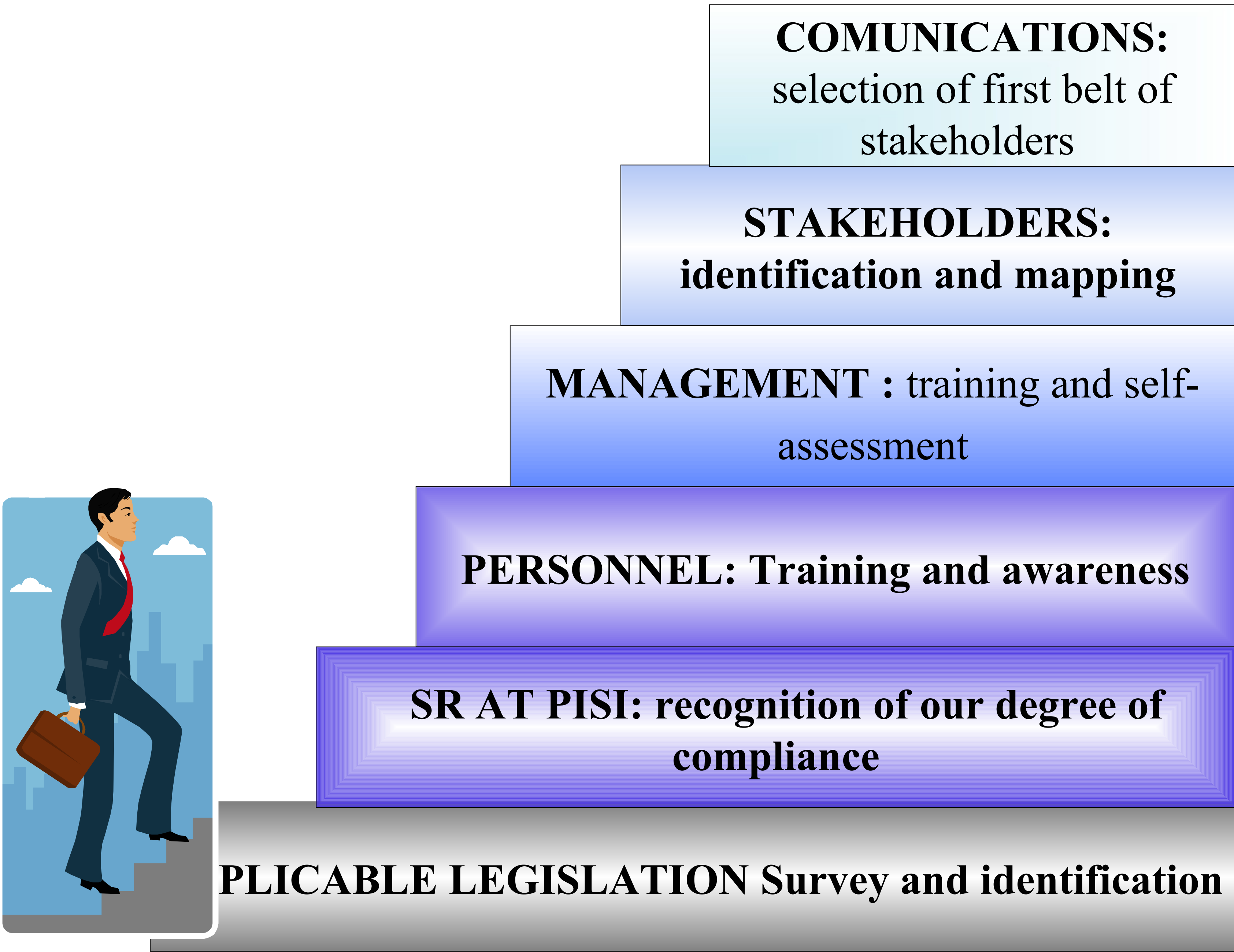

5. RESULTS AND CONCLUSIONS

Among the positive results achieved since the beginning of this project in 2007, there are several outcomes which stand out:

preliminary evaluation	action planning towards the implementation SR	training and self-assessment of management
strengthening of the idiosyncrasies of staff	creation of a shared vision of PISI	Health plan and motivational exercises
stakeholders identification and map	communication with customers, community, internal interfaces at the organization, regulatory bodies , unions	

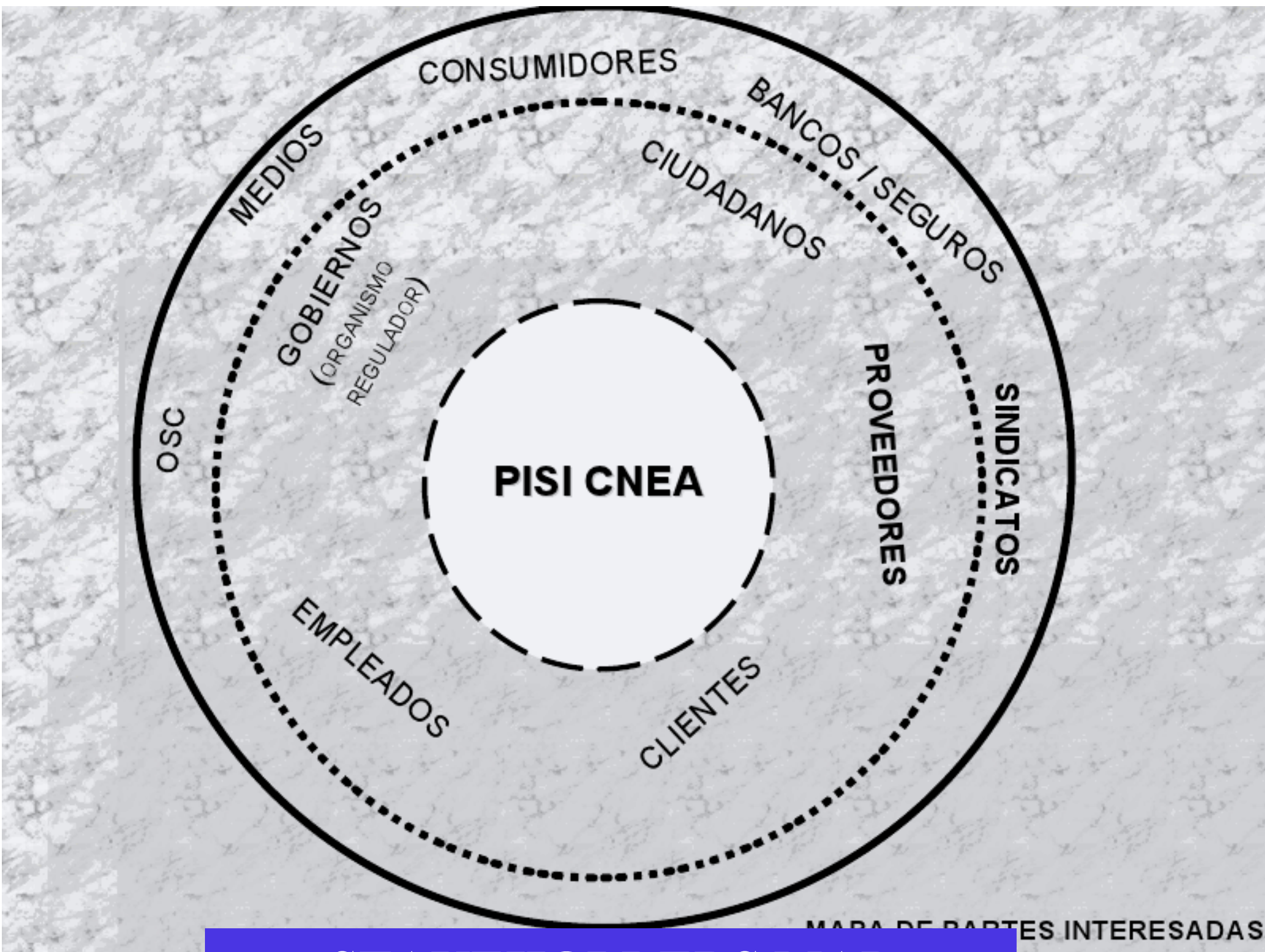

STAKEHOLDERS MAP

We consider that the results of the project have been highly satisfactory, contributing to a large extent to reinforcement of the safety culture of the team of work and our connection with society.